

TIPS FOR GAGE MAINTENANCE;

1. REMOVE KEEPER RING
2. SLIDE OUT SWIVEL PIN
3. SLIDE OUT INSERT AND GLASS
4. CLEAN COMPONENTS AS NEEDED  
(lubricate O-rings before reassembly)
5. INSTALL NEW O-RINGS (-012) ON SWIVEL PIN
6. INSTALL NEW O-RING (-906) IN INSERT
7. SLP BUMPER O-RING (-012) IN INSERT COUNTERBORE
8. SLP TUBULAR GLASS IN INSERT COUNTERBORE  
(if redline glass is used, align stripe opposite view slot)
9. 1st END; SLIDE GLASS AND INSERT INTO BODY  
(align insert with body cross holes; chamfer side opposite view slot)
10. SLP SWIVEL PIN THROUGH BODY AND INSERT CROSS HOLE
11. SNAP ON KEEPER RING
12. 2nd END; SLIDE INSERT ONTO GLASS AND REPEAT STEPS 10 & 11

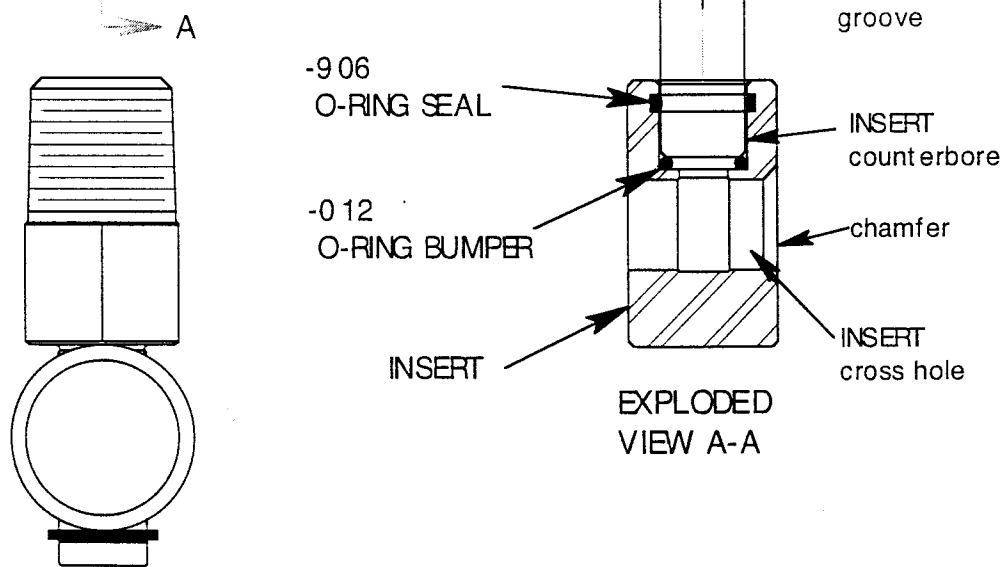
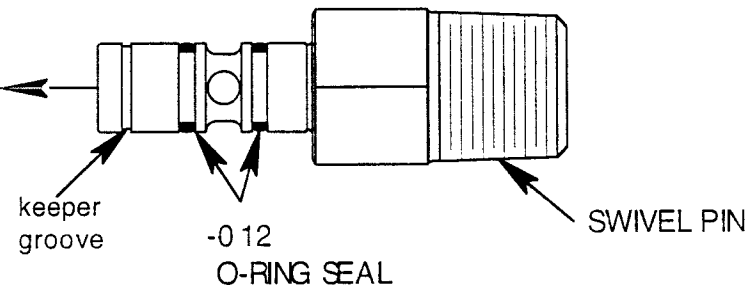

Property of Inferno Mfg. Corp.  
not to be reproduced without  
permission

Inferno Mfg. Corp.  
ATS; Assembly Instruction  
Dwg: A96894-24  
Rev Ø Rev Date  
Created: 7/30/01  
Drawn by: JK Appvd. by: AO