

R100 Series Level Gage- Reflex Style

for Liquid-Vapor level reading

Reflex reads **SILVERY-WHITE** in vapor;
reads **BLACK** in Liquid, even clear service such as water,
hydrocarbon condensate, or ammonia

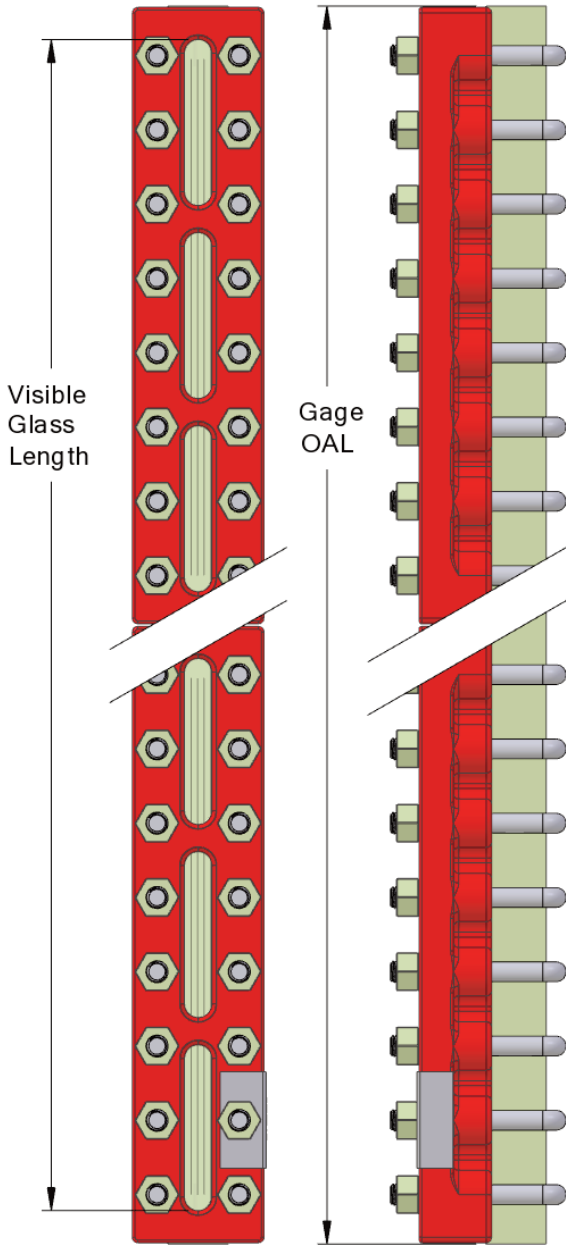

Model No. Visible Length Overall Length Weight

* OAL and Illustrations pertain to "End Connected" type only. OAL for Close Hook-Up, "CH" type gages is longer and depends on Center-to-Center

Model No.	Visible Length (In)	Overall Length (In)	Weight (Lbs)
R100-13	5.75	7.25	12
R100-14	6.75	8.25	13
R100-15	7.875	9.375	14
R100-16	9.125	10.625	16
R100-17	10.25	11.75	18
R100-18	11.875	13.375	20
R100-19	12.625	14.125	21
R100-24	15	16.5	24
R100-25	17.25	18.75	27
R100-26	19.75	21.25	31
R100-27	22	23.5	34
R100-28	25.25	26.75	39
R100-29	26.75	28.25	41
R100-36	30.375	31.875	46
R100-37	33.75	35.25	51
R100-38	38.625	40.125	58
R100-39	40.875	42.375	61
R100-47	45.5	47	68
R100-48	52	53.5	77
R100-49	55	56.5	81
R100-57	57.25	58.75	85
R100-58	65.375	66.875	96
R100-59	69.125	70.625	102
R100-68	78.75	80.25	116
R100-69	83.25	84.75	122
R100-78	92.125	93.625	135
R100-79	97.375	98.875	142
R100-88	105.5	107	154
R100-89	111.5	113	163
R100-98	118.875	120.375	173
R100-99	125.625	127.125	183
R100-108	132.25	133.75	193
R100-109	139.75	141.25	204
R100-118	145.625	147.125	220
R100-119	153.875	155.375	231
R100-128	159	160.5	240

Pressure Ratings, PSI factory hydrotested to 1.3 x						
Exception: Steam Service limited to 250 WSP						
100° F	200° F	300° F	400° F	500° F	572° F	
2810	2720	2620	2520	2330	2090	
2710	2640	2540	2440	2270	2010	
2630	2550	2450	2360	2190	1950	
2540	2450	2370	2280	2100	1870	
2440	2370	2280	2200	2020	1800	
2340	2280	2200	2110	1950	1730	
2250	2190	2100	2030	1870	1670	
2710	2640	2540	2440	2270	2010	
2630	2550	2450	2360	2190	1950	
2540	2450	2370	2280	2100	1870	
2440	2370	2280	2200	2020	1800	
2340	2280	2200	2110	1950	1730	
2250	2190	2100	2030	1870	1670	
2710	2640	2540	2440	2270	2010	
2630	2550	2450	2360	2190	1950	
2540	2450	2370	2280	2100	1870	
2440	2370	2280	2200	2020	1800	
2340	2280	2200	2110	1950	1730	
2250	2190	2100	2030	1870	1670	
2710	2640	2540	2440	2270	2010	
2630	2550	2450	2360	2190	1950	
2540	2450	2370	2280	2100	1870	
2440	2370	2280	2200	2020	1800	
2340	2280	2200	2110	1950	1730	
2250	2190	2100	2030	1870	1670	
2710	2640	2540	2440	2270	2010	
2630	2550	2450	2360	2190	1950	
2540	2450	2370	2280	2100	1870	
2440	2370	2280	2200	2020	1800	
2340	2280	2200	2110	1950	1730	
2250	2190	2100	2030	1870	1670	
2710	2640	2540	2440	2270	2010	
2630	2550	2450	2360	2190	1950	
2540	2450	2370	2280	2100	1870	
2440	2370	2280	2200	2020	1800	
2340	2280	2200	2110	1950	1730	
2250	2190	2100	2030	1870	1670	
2710	2640	2540	2440	2270	2010	
2630	2550	2450	2360	2190	1950	
2540	2450	2370	2280	2100	1870	
2440	2370	2280	2200	2020	1800	
2340	2280	2200	2110	1950	1730	
2250	2190	2100	2030	1870	1670	
2710	2640	2540	2440	2270	2010	
2630	2550	2450	2360	2190	1950	
2540	2450	2370	2280	2100	1870	
2440	2370	2280	2200	2020	1800	
2340	2280	2200	2110	1950	1730	
2250	2190	2100	2030	1870	1670	
2710	2640	2540	2440	2270	2010	
2630	2550	2450	2360	2190	1950	
2540	2450	2370	2280	2100	1870	
2440	2370	2280	2200	2020	1800	
2340	2280	2200	2110	1950	1730	
2250	2190	2100	2030	1870	1670	
2710	2640	2540	2440	2270	2010	
2630	2550	2450	2360	2190	1950	
2540	2450	2370	2280	2100	1870	
2440	2370	2280	2200	2020	1800	
2340	2280	2200	2110	1950	1730	
2250	2190	2100	2030	1870	1670	

Maximum continuous operating temperature decreased from 600°F to 572°F based on glass manufacturer's published rating for tempered borosilicate.

Exception: Hot oil / thermal transfer fluid applications with borosilicate glass permitted up to 600°F, limited to 145 PSI max.

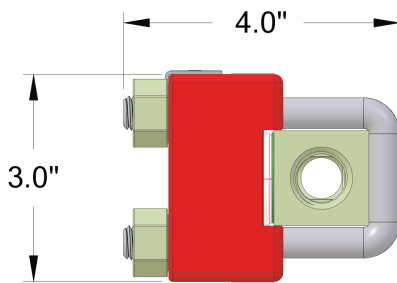

End Connections

- 1/2" F-NPT standard
- 3/4" F-NPT optional

Materials of Construction:

See [M191980](#) for popular options

- Tempered borosilicate glass, Maxos® brand
- Gage body (wetted) per NACE
- Cover flanges, powder coated steel (Standard) or stainless
- B7 bolting, zinc plated (standard)
- B7M de-rate 20%
- B8M Class 2, de-rate 15%
- Flexible graphite seal / compressed fiber cushion
- Cross Ties for added strength, undercut permits "behind-the-bar" vision for complete view, design validated by FEA
- Gage support for long / heavy gages (either factory-welded brackets or lift-from-below angle plate)
- Large thru-bore (0.59 Ø) between sections allows brush access for cleaning

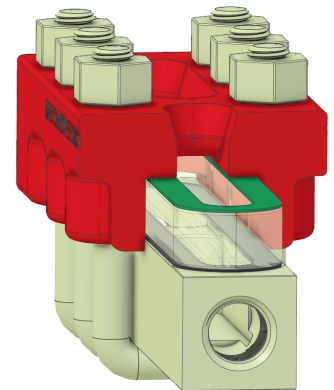

Drawing R100

Revision: C Rev. Date: 5/17/2022

Created: 7/30/2007